

氣壓缸理論出力表：

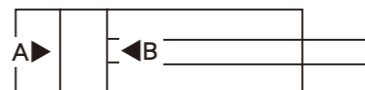

單位：N

缸徑(mm)	12	16	20	25	32	40	50	63	80	100	125	150	200
桿徑(mm)	6	6	8	10	12	16	20	20	25	25	35	40	50
活塞受壓面積(mm²)	A	B	A	B	A	B	A	B	A	B	A	B	A
操作壓力 (MPa)	0.1	113	201	314	491	804	1257	1963	3117	5027	7854	12271	17671
	0.2	85	173	264	412	691	1056	1649	2803	4536	7363	11309	16415
	0.3	11	20	31	49	80	126	196	312	502	785	1227	1767
	0.4	8.5	17	26	41	69	106	165	280	453	736	1131	1642
	0.5	23	40	63	98	161	251	393	623	1005	1571	2454	3534
	0.6	17	35	53	82	138	211	330	561	907	1473	2262	3283
	0.7	34	60	94	147	241	377	589	935	1508	2356	3681	5301
	0.8	25	52	79	124	207	317	495	841	1361	2209	3393	4925
	0.9	45	80	126	196	322	503	785	1247	2011	3142	4908	7068
	1.0	34	69	106	165	276	422	660	1121	1814	2945	4524	6566
	1.1	57	101	157	245	402	629	982	1559	2514	3927	6135	8836
	1.2	42	87	132	206	346	528	825	1402	2268	3682	5655	8208
	1.3	68	121	189	294	482	754	1178	1870	3016	4712	7363	10603
	1.4	51	104	158	247	415	634	989	1682	2722	4418	6785	9849
	1.5	79	141	220	343	563	880	1374	2182	3519	5498	8589	12370
	1.6	59	121	185	289	484	739	1154	1962	3175	5154	7916	11491
	1.7	90	161	251	393	643	1006	1570	2494	4022	6283	9816	14137
	1.8	68	138	211	330	553	845	1319	2242	3629	5890	9047	13132
	1.9	102	181	283	442	724	1131	1767	2805	4524	7069	11043	15904
	2.0	76	155	238	371	622	950	1484	2523	4082	6627	10178	14774

氣缸出力計算方式：

$$F = P \times A - f$$

F: 氣缸出力 (N)
P: 操作壓力 (MPa)
A: 活塞受壓面積 (mm²)
f: 摩擦阻力 (N)

壓力單位變換表：

Pa	kPa	MPa	bar	mbar	kgf/cm²	cmH₂O	mmH₂O	mmHg	p.s.i.
1	10 ⁻³	10 ⁻⁶	10 ⁻⁵	10 ⁻²	10.2X10 ⁻⁶	10.2X10 ⁻³	101.97X10 ⁻³	7.5X10 ⁻³	0.15X10 ⁻³
10³	1	10 ⁻³	10 ⁻²	10	10.2X10 ⁻³	10.2	101.97	7.5	0.15
10⁶	10³	1	10	10⁴	10.2	10.2X10³	101.97X10³	7.5X10³	0.15X10³
10⁹	10⁶	10³	10³	10⁷	1.02	1.02X10⁶	10.2X10⁶	750.06	14.5
10¹²	10⁹	10⁶	10⁶	10¹⁰	1.02X10³	1.02	10.2	0.75	14.5X10 ⁻³
98066.5	98.07	98.07X10 ⁻³	0.98	980.67	1	1000	10000	735.56	14.22
98.0665	98.07X10 ⁻³	98.07X10 ⁻⁶	0.98X10 ⁻³	0.98	10 ⁻³	1	10	0.74	14.22X10 ⁻³
9.80665	9.807X10 ⁻³	9.807X10 ⁻⁶	9.807X10 ⁻⁶	9.807X10 ⁻³	10 ⁻⁴	0.1	1	73.56X10 ⁻³	1.42X10 ⁻³
133.32	133.32X10 ⁻³	133.32X10 ⁻⁶	1.33X10 ⁻³	1.33	1.36X10 ⁻³	1.36	13.6	1	19.34X10 ⁻³
6894.76	6.89	6.89X10 ⁻³	68.95X10 ⁻³	68.95	70.31X10 ⁻³	70.31	703.07	51.71	1

FA

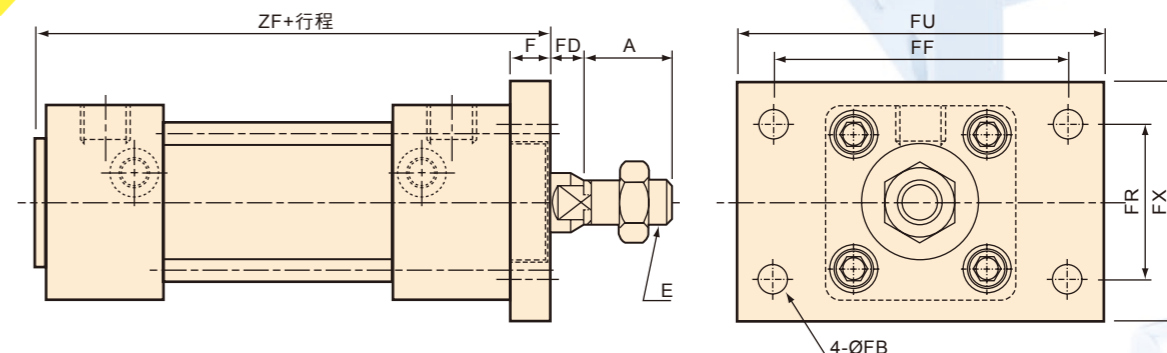

SIZE	A	E	F	FB	FD	FF	FR	FU	FX	ZF
BORE										
Ø40	30	M14X1.5	12	9	9	80	42	100	58	99
Ø50	35	M18X1.5	12	9	11	90	50	110	66	105
Ø63	35	M18X1.5	15	11.5	8	105	59	130	80	116
Ø80	40	M22X1.5	18	14	13	130	76	160	108	138
Ø100	40	M26X1.5	18	14	14	150	92	180	124	149

LB

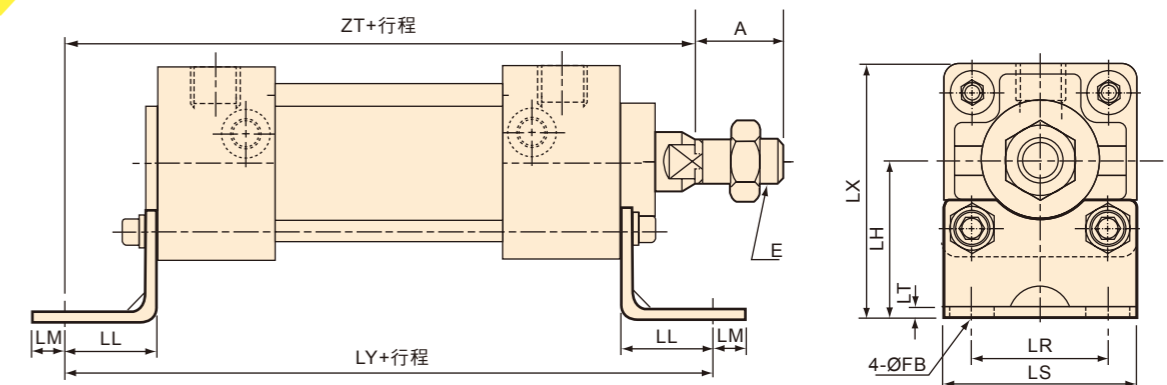

SIZE	A	E	FB	LH	LL	LM	LR	LS	LT	LX	LY	ZT
BORE												
Ø40	30	M14X1.5	9	40	27	13	42	58	3.2	69	138	132
Ø50	35	M18X1.5	9	45	27	13	50	66	3.2	78	144	140
Ø63	35	M18X1.5	11.5	50	34	16	59	80	4.5	90	166	155
Ø80	40	M22X1.5	14	65	44	16	76	100	6	115	204	191
Ø100	40	M26X1.5	14	75	43	17	92	118	6	134	212	201

謙泰空油壓有限公司

● 地址：台北縣三重市重新路一段42號(台北橋邊)
● TEL: 02-29733752, 29725258, 29735107~8
● FAX: 02-29735109
● E-mail: chian.tay@msa.hinet.net

Ø12, Ø16

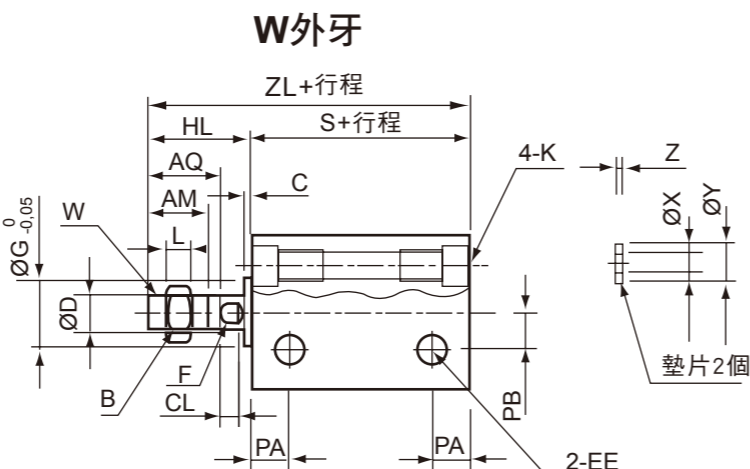
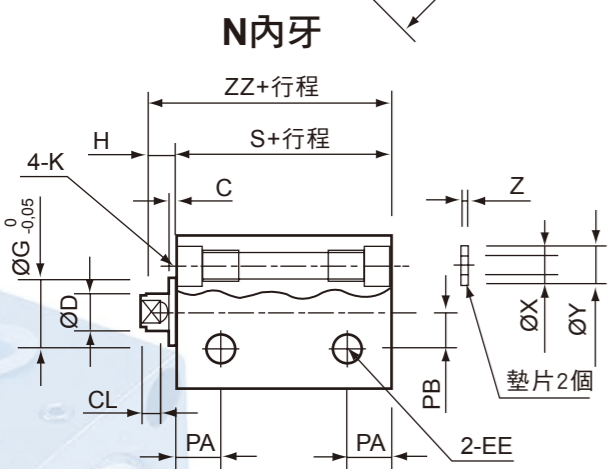
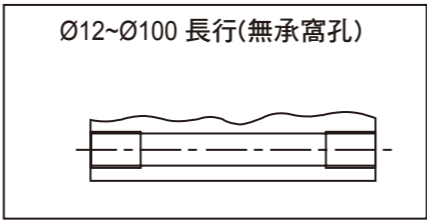
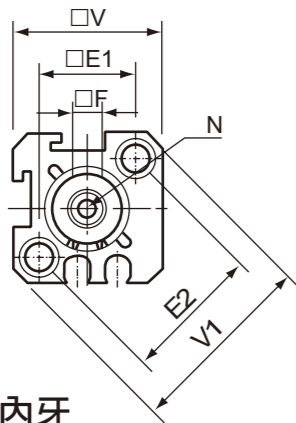

Ø20, Ø25

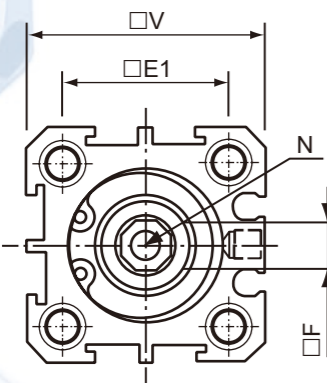

Ø32, Ø100

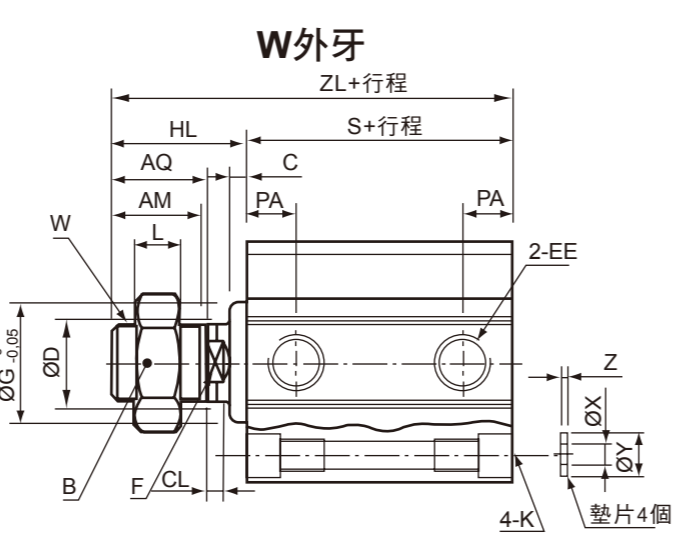
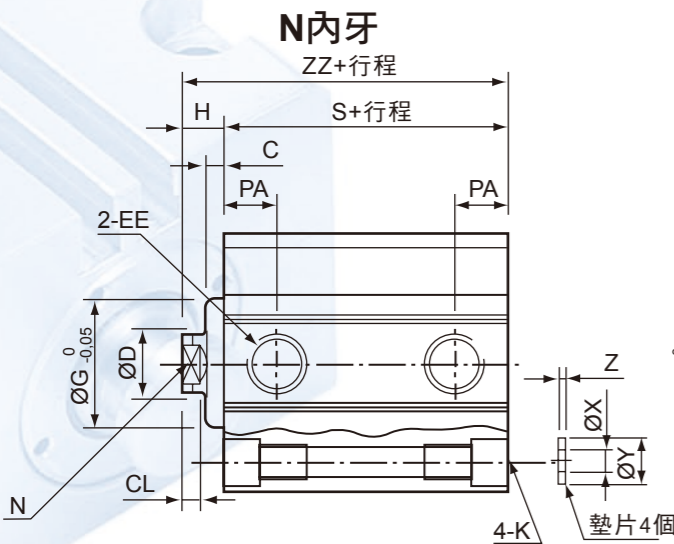
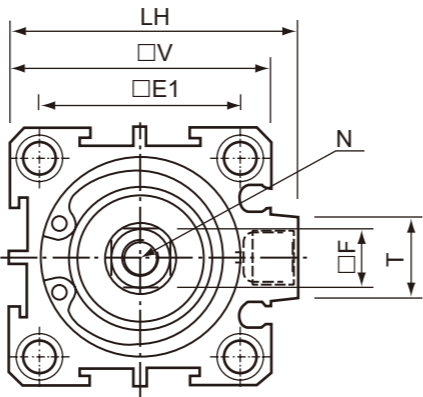

表示方法：

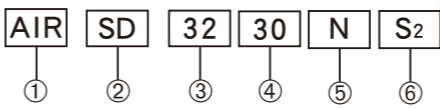

1	薄型氣壓缸
2	型式
3	氣壓缸內徑(mm)
4	氣壓缸行程(mm)
5	活塞桿型式：N內牙、W外牙、T車溝
6	感應線2條 不感應S2不表示

SIZE BORE	C	ØD	EE	E1	E2	F	ØG	H	CL	L	N內牙	LH	4-K(固定孔)	PA	PB	T	V
Ø12	1	6	M5X0.8	16.3	23	5	11	5	3	4	M3X0.5X6深	-	6.5X4.5深，貫通Ø4.3，M5X0.8X7.5深	6.5	6	-	25
Ø16	1.5	6	M5X0.8	19.8	28	5	11	5.5	3	4	M3X0.5X6深	-	6.5X4.5深，貫通Ø4.3，M5X0.8X7.5深	7	6.5	-	29
Ø20	1.5	8	M5X0.8	24	-	6	15	5.5	3	5	M4X0.7X8深	-	6.5X4.5深，貫通Ø4.3，M5X0.8X7.5深	7.5	-	-	34
Ø25	2	10	M5X0.8	28	-	8	17	6	3	5	M5X0.8X10深	-	9X7深，貫通Ø5.1，M6X1X10深	8	-	-	40
Ø32	3	12	G 1/8	34	-	10	22	7	3	6	M6X1X12深	48.5	9X7深，貫通Ø5.1，M6X1X10深	9	-	14	44
Ø40	3	16	G 1/8	40	-	14	28	7	3	8	M8X1.25X12深	56.5	10.5X8深，貫通Ø6.9，M8X1.25X12.5深	10	-	14	52
Ø50	4	20	G 1/4	48	-	17	38	9	3	11	M10X1.5X15深	70	11X8.5深，貫通Ø6.9，M8X1.25X16.5深	10	-	19	62
Ø63	4	20	G 1/4	60	-	17	40	9	3	11	M10X1.5X15深	83	11X8.5深，貫通Ø6.9，M8X1.25X16.5深	12	-	20	75
Ø80	5	25	G 3/8	74	-	22	45	11	4	13	M14X1.5X20深	102	14X10.5深，貫通Ø10.5，M12X1.75X12深	12.5	-	27	94
Ø100	5	30	G 3/8	90	-	27	45	12	4	14	M18X1.5X20深	122	17.5X13深，貫通Ø12.3，M14X2X17深	17	-	26	114

SIZE BORE	V1	X	Y	Z	AM	AQ	B	HL	W外牙	S	ZL	ZZ
Ø12	32	3.2	6.3	1	10	12	8	17	M5X0.8	27	44	32
Ø16	38	3.2	6.3	1	10	12	8	17.5	M5X0.8	28.5	46	34
Ø20	-	3.2	6.3	1	13	15	10	20.5	M6X1	29.5	50	35
Ø25	-	4.2	7.8	1	15	17	13	23	M8X1.25	31	54	37
Ø32	-	4.2	7.8	1	15	18	17	25	M10X1.25	34.5	59.5	41.5
Ø40	-	6.2	10.3	1.6	25	28	22	35	M14X1.5	36	71	43
Ø50	-	6.2	10.8	1.6	25	28	26	37	M18X1.5	38	75	47
Ø63	-	6.2	10.8	1.6	25	28	26	37	M18X1.5	42	79	51
Ø80	-	8.2	13.8	1.6	30	33	32	44	M22X1.5	51	95	62
Ø100	-	10.2	17.3	2	35	38	35	50	M26X1.5	61	111	73

謙泰空油壓有限公司

● 地址：台北縣三重市重新路一段42號(台北橋邊)
● TEL: 02-29733752, 29725258, 29735107~8
● FAX: 02-29735109
● E-mail: chian.tay@msa.hinet.net